

Dynamic module DM2...ZR... with toothed belt drive

DM	Toothed belt drive		Axial load rating	Positioning accuracy	Repeating accuracy	Acceleration
	Stroke/R [mm]	Elongation ³⁾ [mm/m]	F [N]	[μm/mm]	.../1000 mm [mm]	a _{max} [m/s ²]
DM2.ZR...	320	0.037 ¹⁾	200/1000 ²⁾	± 0.05 ²⁾	50.0 ⁴⁾

¹⁾ Depends on speed and load

²⁾ Without considering backlash and load

³⁾ Belt elongation/metre [mm/m] per 100 N tensile force

⁴⁾ Maximum possible value; precise value for your specific application to be determined with our technical sales department

DM	Travel speed		Area moment of inertia		Stroke max. [mm]	Feed and friction force F _V [N]	Mass transported m _b [kg]
	Guide v _{max} [m/min]	Drive v _{max} [m/min]	I _y [cm ⁴]	I _z [cm ⁴]			
DM2.ZR...A/B/C... ⁶⁾	360 ⁷⁾	5 ⁵⁾	1780	3184	5880 ⁶⁾	65	6.4
DM2.ZR...D/E/F... ⁶⁾	360 ⁷⁾	5 ⁵⁾	1780	3184	5880 ⁶⁾	80	7.2

⁵⁾ Depends on load, rotation speed, and permissible travel speed of the guides

⁶⁾ Longer strokes on request

⁷⁾ Higher speeds on request

⁸⁾ ...A/B/C... = 4 runner blocks / ...D/E/F... = 6 runner blocks

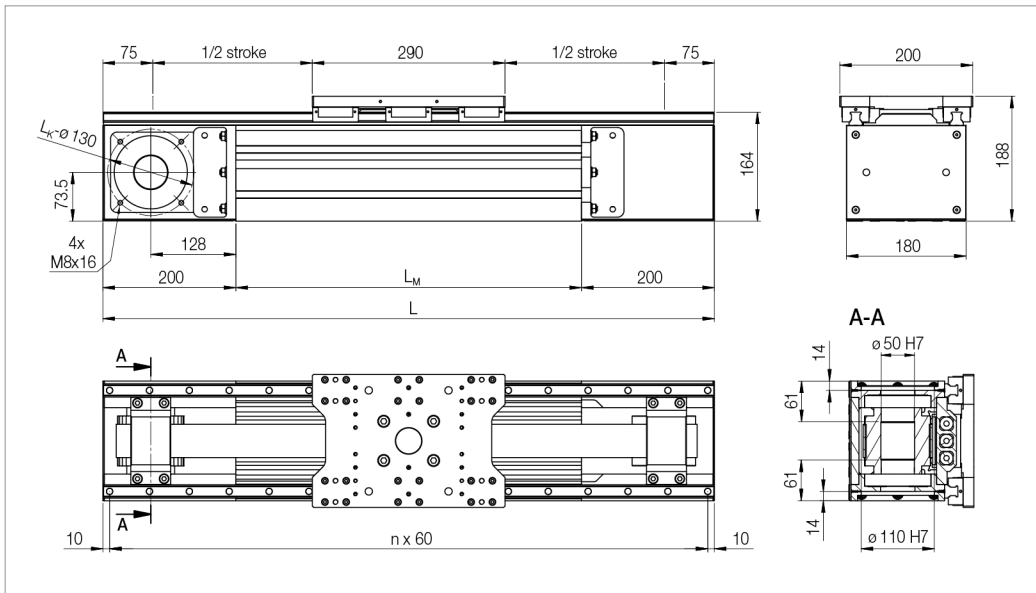

Nominal size	Dimensions			
	Designation	L [mm]	L _M [mm]	Belt length [mm]
DM2.ZR...A/B/C... ¹⁾	Stroke * + 440	L - 400	2 x Stroke + 880	24.34 kg + 2.688 kg/100 mm Stroke
DM2.ZR...D/E/F... ¹⁾	Stroke * + 440	L - 400	2 x Stroke + 880	25.11 kg + 2.688 kg/100 mm Stroke

* Possible strokes = 360 mm / 420 mm / 480 mm / ... every 60 mm ... / 5760 mm / 5820 mm / 5880 mm

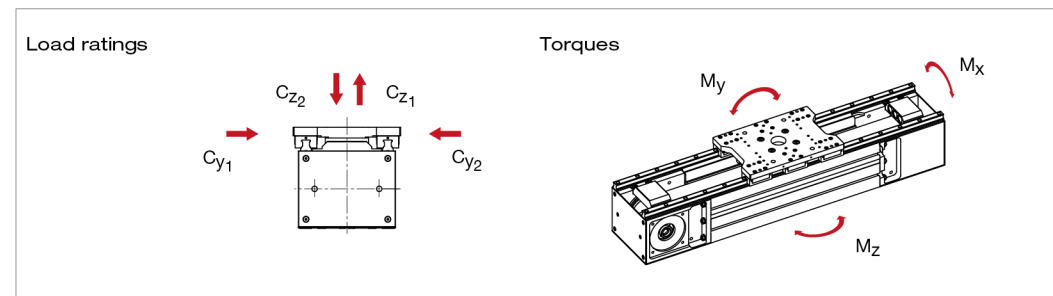

Dynamic module	Maximum permissible forces [kN]				Maximum permissible torques [Nm]					
	static		dynamic		static			dynamic		
	C _{y0,1,2}	C _{z0,1,2}	C _{y1,2,50}	C _{z1,2,50}	M _{x0}	M _{y0}	M _{z0}	M _{x50}	M _{y50}	M _{z50}
DM2.ZR...A/B/C... ¹⁾	108	108	77.5	77.5	8200	11880	11880	5900	8530	8530
DM2.ZR...D/E/F... ¹⁾	162.0	162.0	116.3	116.3	12310	12080	12080	8840	8790	8790

¹⁾ ...A/B/C... = 4 runner blocks / ...D/E/F... = 6 runner blocks

For CAD data, contact LINE TECH →

Enquiry (technical/quote)

Download data sheet (PDF)

Download catalogue (PDF)